

# Elmwood Park Public Schools

## Enrollment Projection and Facility Utilization Study



*prepared by*

**Ross Haber and Associates**

**February 27, 2018**

## Overview

### Enrollment Projections:

- Cohort Survival Model-In compliance with DOE Requirements
- Based upon six years of enrollment history
- Analysis of new housing developments
- Creating projections by District and By School

### Facility Utilization:

- Survey provided to each building principal
- Analysis of current building floor plans
- Review of DOE Facility Efficiency Standards Documents
- Interview with each principal
- Walk through of each of the school buildings.

How Changes in Educational and Special Education  
Requirements Have Changes School Capacities

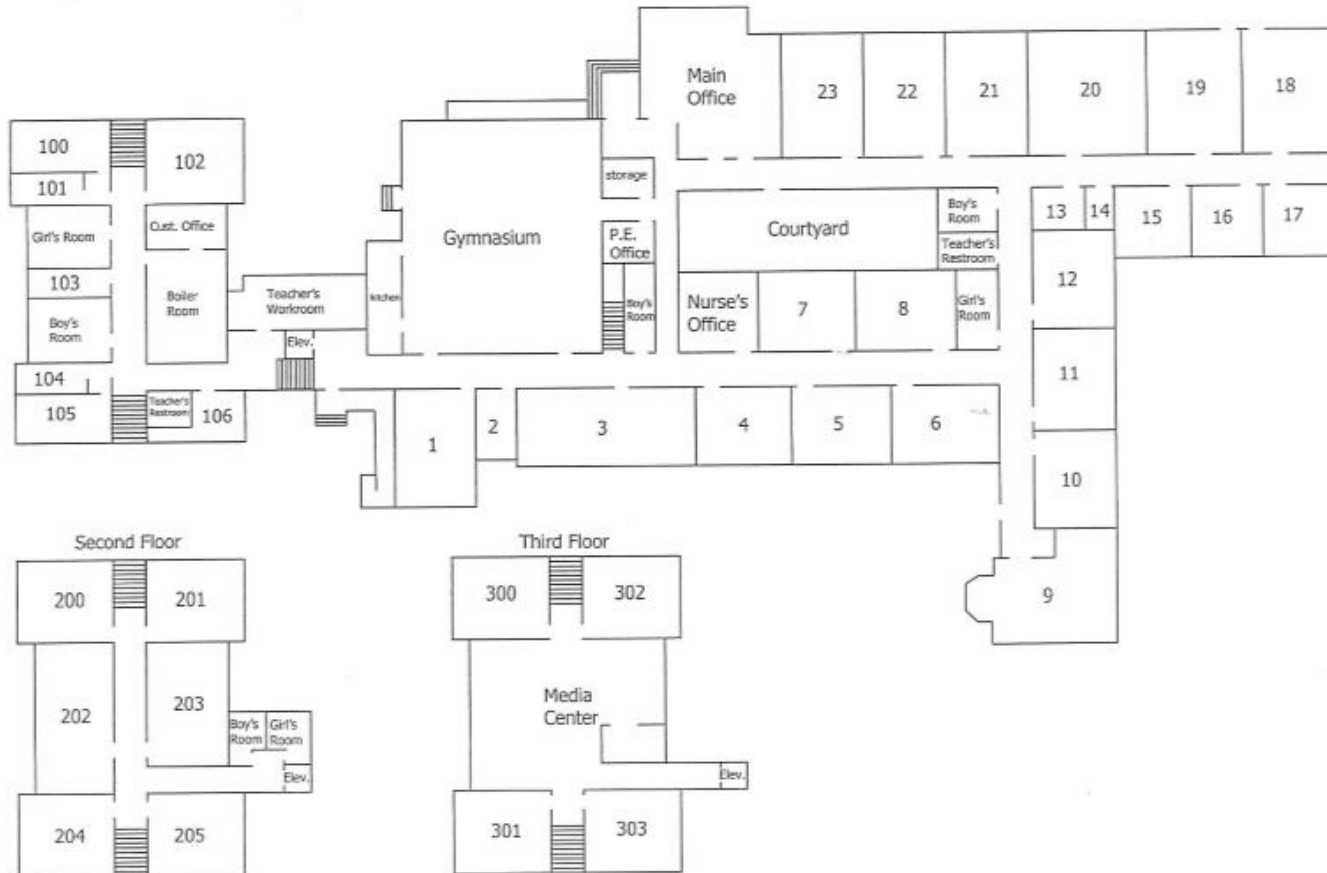

## 1965 Elementary School

Capacity = 750

Total Classrooms=30

Minus: Dedicated Art Room; Dedicated Music Room

Average Class Size (in 28 General Education Classes) = 27 Students Per Class



## 1975 Elementary School

Capacity = 750

Total Classrooms=30

Minus: 1 Dedicated Art Room; 1 Dedicated Music Room; 1 room self-contained special education

1 resource room

Average Class Size (in 26 General Education Classes) = 29 Students Per Class



## 1985 Elementary School

Enrollment = Capacity 750

Total Classrooms=30

Minus: 1 Dedicated Art Room; 1 Dedicated Music Room; 1 room self-contained special education

1 resource room; computer lab

Average Class Size (in 25 General Education Classes) = 30 Students Per Class

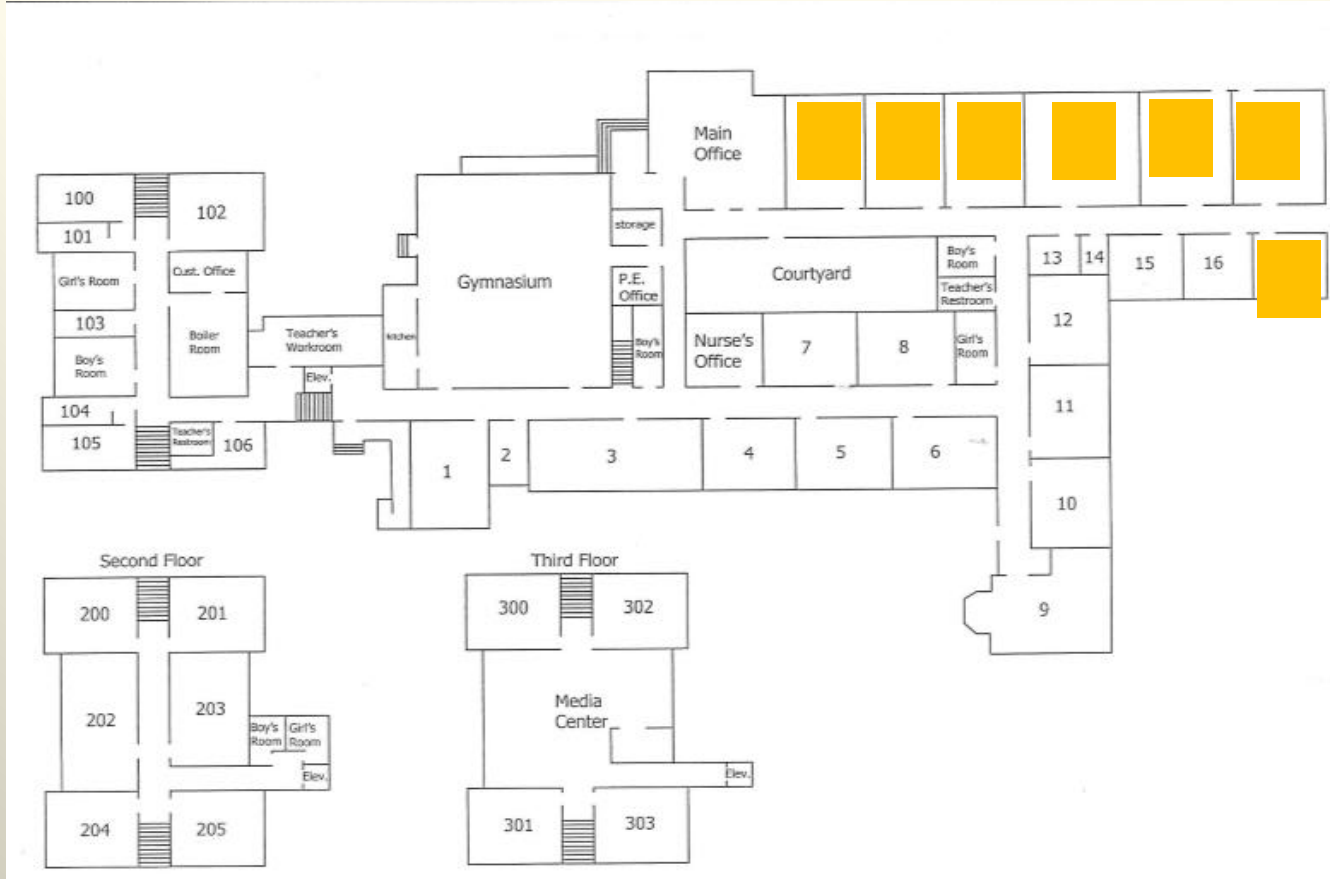

## 2018 Elementary School

Enrollment = Capacity 750

Total Classrooms=30

Minus: 1 Dedicated Art Room; 1 Dedicated Music Room; 1 room self-contained special education

1 resource room; computer lab; 1 ESL; 1 OT/PT; 1 Speech; 1 World Language

Average Class Size (in 21 General Education Classes) = 36 Students Per Class

To get back to the average class size of 1965 which was 27 students per class the actual capacity would approximately 540 students. A building built for 750 in 1965 might only have a true capacity of 540 in 2018. That would still be an average of 27 students per class which by today's standards is very high.

## Enrollment History and Projection Summary

	2012-13	2017-18	Difference	Percent	2022-23	Diff	Percent
				Difference			
District	2,556	2,638	82	3.21%	2,829	191	7.24%
Gantner	341	330	-11	-3.23%	361	31	9.39%
Gilbert	383	431	48	12.53%	455	24	5.57%
Sixteenth	420	426	6	1.43%	457	31	7.28%
Middle School	545	590	45	8.26%	591	1	0.17%
High School	749	741	-8	-1.07%	828	87	11.74%
PK	25	40	15		43	3	
SCSE	93	80	-13		94	14	
Total	2,556	2,638			2,829	177	6.71%



## District-Wide Enrollment History and Projection

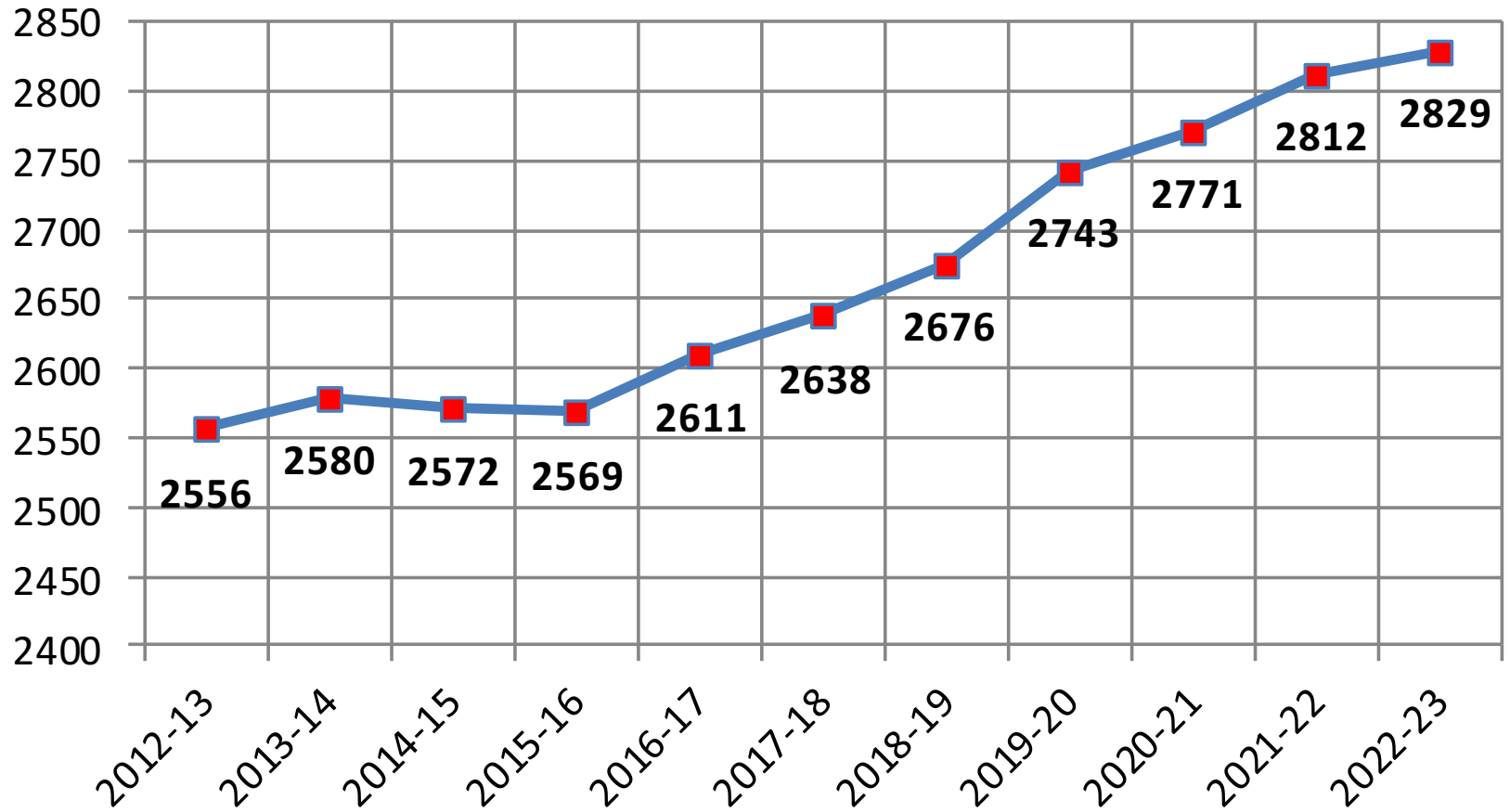

# **Elementary Schools**

# Gantner Elementary School

Gantner Full Sized Classroom Utilization													
General Education / PK/Special Education													
	K	1	2	3	4	5	SCSE	PK	Total	Rooms	Available	Diff	Cl Sz
	25	30	30	30	30	30				Needed			(Gr 1-5)
<b>2018-19</b>	60	49	50	63	50	50	35	0	357				
Rooms	2.40	1.63	1.67	2.10	1.67	1.67	3.00			14.14	17	2.9	
Actual	3	2	2	3	2	2	3			17	17	0	
Av Cl Size	20	25	25	21	25	25							24
Gantner Full Sized Classroom Utilization													
General Education / PK/Special Education													
	K	1	2	3	4	5	SCSE	PK	Total	Rooms	Available	Diff	Cl Sz
	25	30	30	30	30	30				Needed			(Gr 1-5)
<b>2019-20</b>	60	65	47	50	62	51	32		367				
Rooms	2.40	2.17	1.57	1.67	2.07	1.70	3.00			14.58	17	2.4	
Actual	3	3	2	2	3	2	3			18	17	-1	
Av Cl Size	20	22	24	25	21	26							24
Gantner Full Sized Classroom Utilization													
General Education / PK/Special Education													
	K	1	2	3	4	5	SCSE	PK	Total	Rooms	Available	Diff	Cl Sz
	25	30	30	30	30	30				Needed			(Gr 1-5)
<b>2020-21</b>	57	65	63	49	50	64	31	0	379				
Rooms	2.28	2.17	2.10	1.63	1.67	2.13	3.00			14.98	17	2.0	
Actual	3	3	3	2	2	3	3			19	17	-2	
Av Cl Size	19	22	21	25	25	21							23
Gantner Full Sized Classroom Utilization													
General Education / PK/Special Education													
	K	1	2	3	4	5	SCSE	PK	Total	Rooms	Available	Diff	Cl Sz
	25	30	30	30	30	30				Needed			(Gr 1-5)
<b>2021-22</b>	60	63	63	63	47	50	31	0	377				
Rooms	2.40	2.10	2.10	2.10	1.57	1.67	3.00			14.94	17	2.1	
Actual	3	3	3	3	2	2	3			19	17	-2	
Av Cl Size	20	21	21	21	24	25							22
Gantner Full Sized Classroom Utilization													
General Education / PK/Special Education													
	K	1	2	3	4	5	SCSE	PK	Total	Rooms	Available	Diff	Cl Sz
	25	30	30	30	30	30				Needed			(Gr 1-5)
<b>2022-23</b>	59	65	60	64	64	49	30		391				
Rooms	2.36	2.17	2.00	2.13	2.13	1.63	3.00			15.42	17	1.6	
Actual	3	3	2	3	3	2	3			19	17	-2	
Av Cl Size	20	22	30	21	21	25							24

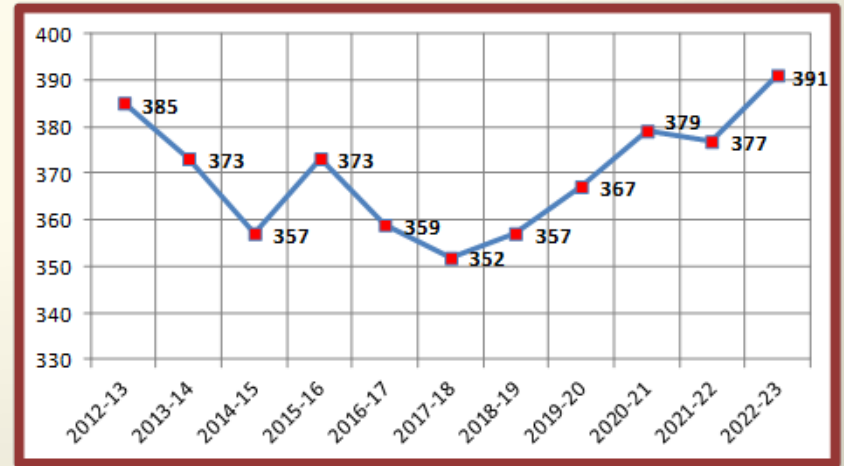

This table shows Gantner room utilization from 2018-19 through 2022-23. Gantner has a total of 17 general education classrooms which are full sized rooms. This includes the art room which is now used as a general education classroom. This study used a maximum of 30 students per class for grades 1 - 5 and a maximum of 25 students per grade for kindergarten. The table provides a projection of the need for full sized classrooms in the school. This includes general education students and students with special needs. During the 2017-18 school year and for the 2018-19 school year the building is fully utilized. The projection indicates that in 2019-20 there may be a shortfall of one classroom and between 2020-21 and 2022-23 there may be a shortfall of two classrooms.

The computer lab is located in the library/media center. There are several smaller rooms available that are used for resource and speech. The music program is conducted on the auditorium stage.

# Gilbert Avenue Elementary School

Gilbert Ave Full Sized Classroom													
General Education / PK/Special Education													
	K	1	2	3	4	5	SCSE	PK	Total	Rooms	Available	Diff	Cl Sz
	25	30	30	30	30	30				Needed			(Gr 1-5)
<b>2018-19</b>	71	73	55	75	67	84	6		431				
<i>Rooms</i>	2.84	2.43	1.83	2.50	2.23	2.80	1.00			15.63	24	8.4	
Actual	3	3	2	3	3	3	1			18	20	2	
Av Cl Size	24	24	28	25	22	28							25
Gilbert Ave Full Sized Classroom													
General Education / PK/Special Education													
	K	1	2	3	4	5	SCSE	PK	Total	Rooms	Available	Diff	Cl Sz
	25	30	30	30	30	30				Needed			(Gr 1-5)
<b>2019-20</b>	75	74	74	57	76	70	7		433				
<i>Rooms</i>	3.00	2.47	2.47	1.90	2.53	2.33	1.00			15.70	24	8.3	
Actual	3	3	3	2	3	3	1			18	20	2	
Av Cl Size	25	25	25	29	25	23							25
Gilbert Ave Full Sized Classroom													
General Education / PK/Special Education													
	K	1	2	3	4	5	SCSE	PK	Total	Rooms	Available	Diff	Cl Sz
	25	30	30	30	30	30				Needed			(Gr 1-5)
<b>2020-21</b>	71	77	75	74	57	80	8		442				
<i>Rooms</i>	2.84	2.57	2.50	2.47	1.90	2.67				14.95	24	9.1	
Actual	3	3	3	3	2	3	1			18	20	2	
Av Cl Size	24	26	25	25	29	27							26
Gilbert Ave Full Sized Classroom													
General Education / PK/Special Education													
	K	1	2	3	4	5	SCSE	PK	Total	Rooms	Available	Diff	Cl Sz
	25	30	30	30	30	30				Needed			(Gr 1-5)
<b>2021-22</b>	71	73	77	77	76	61	8		443				
<i>Rooms</i>	2.84	2.43	2.57	2.57	2.53	2.03	1.00			15.97	24	8.0	
Actual	3	3	3	3	3	3	1			19	20	1	
Av Cl Size	24	24	26	26	25	20							24
Gilbert Ave Full Sized Classroom													
General Education / PK/Special Education													
	K	1	2	3	4	5	SCSE	PK	Total	Rooms	Available	Diff	Cl Sz
	25	30	30	30	30	30				Needed			(Gr 1-5)
<b>2022-23</b>	72	74	74	80	77	78	8		463				
<i>Rooms</i>	2.88	2.47	2.47	2.67	2.57	2.60	1.00			16.66	24	7.3	
Actual	3	3	3	3	3	3	1			19	20	1	
Av Cl Size	24	25	25	27	26	26							26

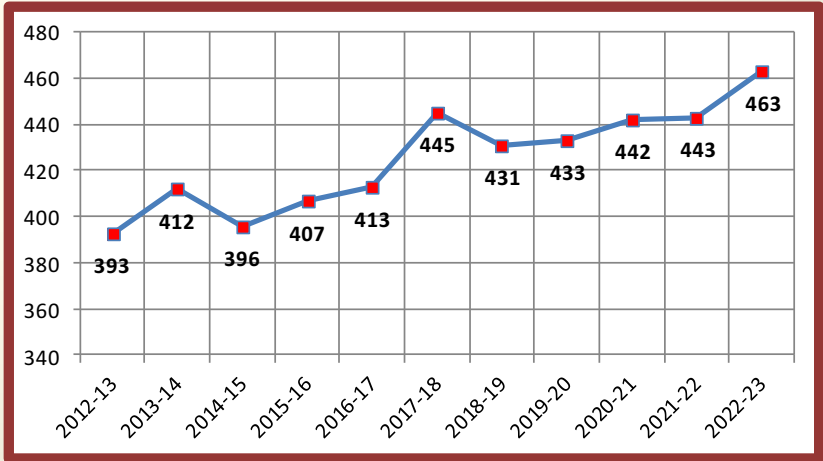

This table is the Gilbert Utilization table for the years 2017-18 (current year) to 2022-23. For grades 1 - 5 a maximum of 30 students per section was used. For kindergarten the maximum was 25. The building has 20 full sized general education classrooms of which 18 are used for general education and special education classes, one is an art room and one is a faculty room. For the years 2018-19 through 2021-22 all 18 classrooms are needed. For the 2022-23 school year it appears that there will be a shortfall of one room. This could be accommodated by either converting the art room to a general education classroom or relocating, if possible, the faculty room.

Resource rooms (2) and self-contained special education (1) are in smaller classrooms (under 600 square feet). Speech, OT and PT share a small classroom. Small group instruction (2 sections) is also located in smaller classrooms.<sup>1</sup> ESL/Bi-Lingual is also located in a small room. The computer lab is located in the media center. Music programs (band/instrumental music) are located on the stage in the all-purpose room.

This building is fully utilized. It appears that every space is used. There are some program limitations because some of the rooms can only accommodate a very limited number of students. These rooms are generally dedicated to small group instruction. Space, while at a premium, appears to be used efficiently and the school does meet the needs of the students. The school is projected to grow moderately during the next five years. The total projection including pre-K is for an increase of 20 students overall, but the K-5 enrollment is projected to increase by 24. This will require at least one additional section in 2022-23 and this may also have an impact on class sizes.

It is important to note that in 2021-22 and 2022-23 there may be a need to convert the art room into a general education classroom as the projection indicates a need for 19 general education sections in those years.

# Sixteenth Avenue School

Sixteenth Ave Full Sized Classroom													
General Education / PK/Special Education													
	K	1	2	3	4	5	SCSE	PK	Total	Rooms	Available	Diff	ClSz
	25	30	30	30	30	30				Needed			(Gr 1-5)
2018-19	73	83	67	66	61	68	26	24	468				
Rooms	2.92	2.77	2.23	2.20	2.03	2.27	3.00			17.42	24	6.6	
Actual	3	3	3	3	3	3	3	3		24	24	0	
Av Cl Size	24	28	22	22	20	23							23

Sixteenth Ave Full Sized Classroom													
General Education / PK/Special Education													
	K	1	2	3	4	5	SCSE	PK	Total	Rooms	Available	Diff	ClSz
	25	30	30	30	30	30				Needed			(Gr 1-5)
2019-20	74	75	82	68	66	61	22	40	488				
Rooms	2.96	2.50	2.73	2.27	2.20	2.03	3.00			17.69	24	6.3	
Actual	3	3	3	3	3	2	3	3		23	24	1	
Av Cl Size	25	25	27	23	22	31							26

Sixteenth Ave Full Sized Classroom													
General Education / PK/Special Education													
	K	1	2	3	4	5	SCSE	PK	Total	Rooms	Available	Diff	ClSz
	25	30	30	30	30	30				Needed			(Gr 1-5)
2020-21	71	77	74	84	68	64	21	41	500				
Rooms	2.84	2.57	2.47	2.80	2.27	2.13	3.00			18.08	24	5.9	
Actual	3	3	3	3	3	3	3	3		24	24	0	
Av Cl Size	24	26	25	28	23	21							25

Sixteenth Ave Full Sized Classroom													
General Education / PK/Special Education													
	K	1	2	3	4	5	SCSE	PK	Total	Rooms	Available	Diff	ClSz
	25	30	30	30	30	30				Needed			(Gr 1-5)
2021-22	73	73	77	76	84	68	21	41	513				
Rooms	2.92	2.43	2.57	2.53	2.80	2.27	3.00			18.52	24	5.5	
Actual	3	3	3	3	3	3	3	3		24	24	0	
Av Cl Size	24	24	26	25	28	23							25

Sixteenth Ave Full Sized Classroom													
General Education / PK/Special Education													
	K	1	2	3	4	5	SCSE	PK	Total	Rooms	Available	Diff	ClSz
	25	30	30	30	30	30				Needed			(Gr 1-5)
2022-23	73	75	73	77	75	84	20	44	521				
Rooms	2.92	2.50	2.43	2.57	2.50	2.80	3.00			18.72	24	5.3	
Actual	3	3	3	3	3	3	3	3		24	24	0	
Av Cl Size	24	25	24	26	25	28							26

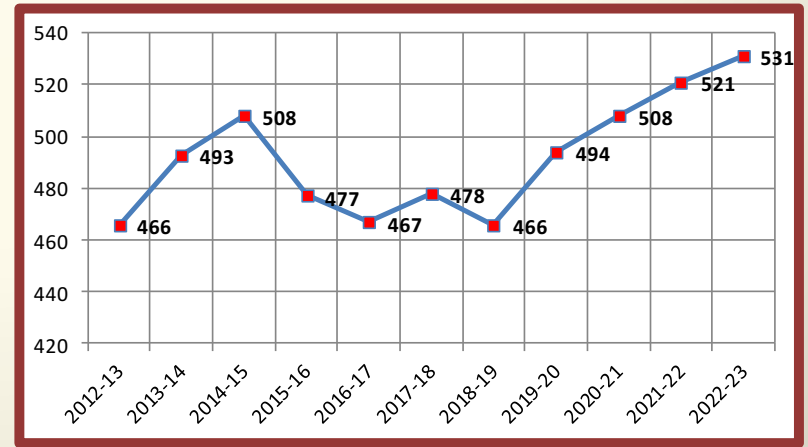

This table shows the utilization for Sixteenth Avenue School. There are 24 full sized classrooms in Sixteenth Ave School. All 24 are used for General Education, special education and pre-Kindergarten. It appears that in terms of classroom space the building is at its maximum. For this study a 25 student maximum was applied to kindergarten. There are three sections of self-contained classes held in smaller rooms. Speech, OT and PT are in smaller rooms. The computer lab is in the media center. There are three large rooms used as resource rooms. Music is conducted in homerooms and band is on the stage of the all-purpose room. The enrollment in the K-5 general education population is projected to grow from the current 426 students to 457 in 2022-23. That is a K-5 increase of 31 students. This will have the potential of creating larger class sizes in this school or driving the need for another section.

Class sizes appear to be primarily in the mid 20's with some as high as 28. It may be difficult to accommodate the future growth anticipated for this school.

# **Secondary Schools**

Elmwood Park HS							
Year	9	10	11	12	Sub Total	Sp Ed	Total
2012-13	193	203	175	178	749	7	756
2013-14	190	178	174	183	725	13	738
2014-15	210	154	172	196	732	5	737
2015-16	164	179	163	178	684	4	688
2016-17	214	156	192	172	734	16	750
2017-18	201	184	164	192	741	16	757
Year	9	10	11	12	Sub Total	Sp Ed	Total
2018-19	216	177	184	172	749	11	760
2019-20	203	190	177	193	763	10	773
2021-22	207	179	190	186	762	11	773
2022-23	267	182	179	200	828	13	841
2023-24	223	235	182	188	828	12	840

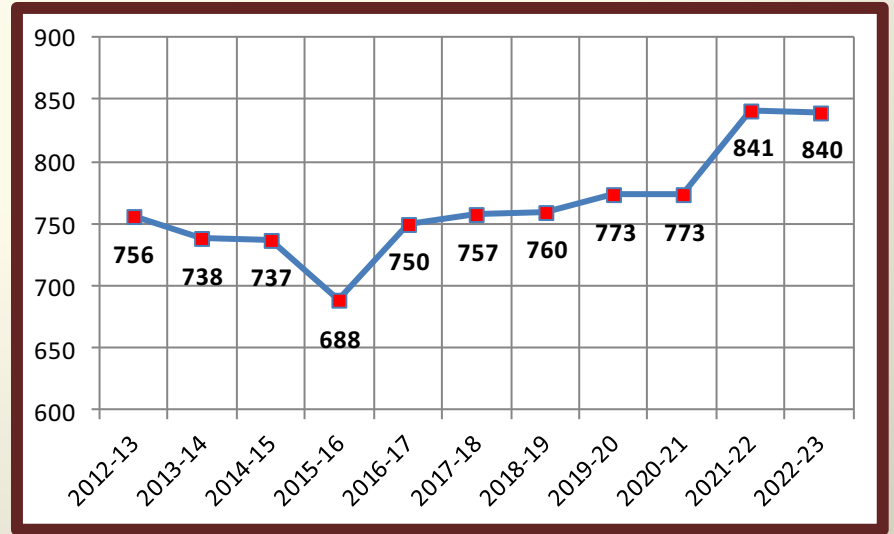

Middle School						
Year	6	7	8	Total	Sp Ed	Total
2012-13	176	191	178	545	11	556
2013-14	190	172	189	551	13	564
2014-15	182	204	165	551	23	574
2015-16	201	186	206	593	31	624
2016-17	194	204	197	595	27	622
2017-18	193	191	206	590	19	609
Year	6	7	8	Total	Sp Ed	Total
2018-19	249	195	193	637	23	660
2019-20	208	251	197	656	25	681
2020-21	187	210	254	651	25	676
2021-22	214	189	212	615	24	639
2022-23	184	216	191	591	23	614

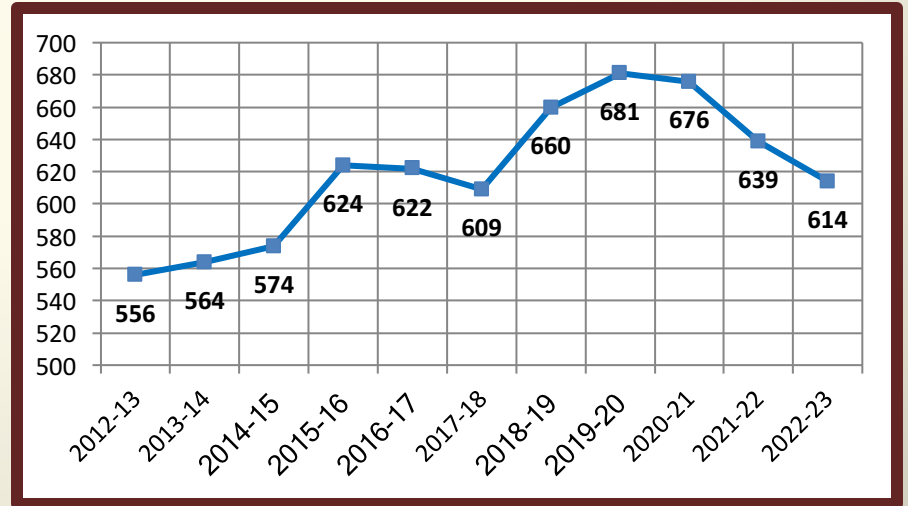



## Critical Classroom Count Analysis

The nature of secondary schools, particularly a high school, is complicated in terms of creating a facility analysis. The nature of a high school schedule, the large variety of courses (required and elective) and the existence of singleton and doubleton (courses offered in only one or two section a semester), does create challenges in both student schedules and room assignments. In order to assess the efficiency of utilization of classroom space in a high school we use a concept called critical classroom count analysis. The rationale for the use of this concept is that there are a certain number of required courses and academic electives that are, at a minimum, what the school must provide to its students. It is also critical that the school provides classroom space to meet the needs of students with special needs.

The critical classroom count analysis defines the minimum number of classrooms required to meet the academic needs of general education students. Once done that allows for the count of those full sized classroom which may be needed to provide other required and/or mandated services to the students. Table 12 lists all of the full sized room available at the high school and then blocked out the number of periods each room was used. Included in this table were general education, health and special education rooms used. The percentage for each of the general education used per day was calculated and averaged (health and special education classes were not included in this calculation). Specialized rooms such as art, music and computer rooms were also not included in this calculation. The average utilization for academic classroom utilization for 2017-18 is 62%. Based upon the enrollment and the building capacity this shows that the high school is utilized well. This is also evident in reviewing average class sizes. While some academic classes do have as many as 30 students the majority of class sizes, on average, appear to be in the low 20's.

In a discussion with the high school principal it was stated that space was not a problem in the high school, and, if more resources were made available (i.e.-teaching staff) given the amount of available rooms space, that it might be possible to expand academic course offerings for students in key academic areas.

The issue that must also be considered in future plans for the high school is that during the next five years (through 200-23) the high school is projected to grow from the current 741 to 902. That is a projected increase of 21.7%. This could have an impact on both room utilization and staffing needs.

## **Conclusion**

During the course of this study we had the opportunity to visit each of the schools. We were impressed with the maintenance of each of the buildings both in terms of cleanliness and atmosphere. It is apparent that the teachers and the administrators take pride in the appearance of their buildings. We were also impressed with the manner in which the principals find space in each of their buildings to accommodate the needs of their students.

The major concern that we have is that the District enrollment is growing, especially at the elementary and high school levels. For the elementary schools it appears that they are using every available space. Further, in many cases class sizes are in excess of 25 students per class and with limited space available it appears that this number could get higher. None of the elementary schools are losing enrollment. It appears that even moving some students from one school to another to lower class sizes will have limited benefits.

As far as the high school is concerned at this time classroom space is not an issue, but it is possible that this will change as the high school enrollment increases during the next five years. The middle school appears to have room and with some scheduling adjustments, possible repurposing of some rooms along with additional staff, the school should be able to meet the needs of students based upon the projectio